

Vyhledávání ve zdrojích a patenty

Searching Session 2016 aneb Co se skrývá za vyhledáváním



Miloslav Nič

<http://www.ecomole.com>

How to Patent Intellect - Adrian Bradley

https://www.youtube.com/watch?v=qiMu_tt14fQ



Druhy patentových hledání

- Patentability
- Clearance = freedom to operate search = right to use
search = infringement search
- Validity
- State of the art

ESPACENET

- <https://worldwide.espacenet.com/>



Europäisches Patentamt
European Patent Office
Office européen des brevets

Espacenet
Patent search

Deutsch English Français
Contact
Change country ▼

◀ About Espacenet Other EPO online services ▼

SearchResult list★ My patents list (0)Query historySettingsHelp

Smart search
Advanced search
Classification search

Maintenance news —

Espacenet: free access to the database of over 90 million patents

Smart search: ⓘ Siemens EP 2007
toilet flushing

ClearSearch

Toilet flushing hits

Smart search

Advanced search

Classification search

Quick help

- [Can I subscribe to an RSS feed of the result list?](#)
- [What does the RSS reader do with the result list?](#)
- [Can I export my result list?](#)
- [What happens if I click on "Download covers"?](#)
- [Why is the number of results sometimes only approximate?](#)
- [Why is the list limited to 500 results?](#)
- [Can I deactivate the highlighting?](#)
- [Why is it that certain documents are sometimes not displayed in the result list?](#)
- [Can I sort the result list?](#)
- [What happens if I click on the star icon?](#)
- [What are XP documents?](#)
- [Can I save my query?](#)

Related links

Result list

☐ Select all (0/25)

Compact

Export (CSV | XLS)

Download covers

Print

More than **10,000** results found in the Worldwide database for:
txt = toilet and txt = flushing using Smart search
Only the first **500** results are displayed.

1

Results are sorted by date of upload in database

☐ 1. **TOILET CONCEPTS**

★	Inventor:	Applicant:	CPC:	IPC:	Publication info:	Priority date:
	BEACH DAVID A [US] HUANG KEVIN [US] (+6)	MAG AEROSPACE IND LLC [US]	<u>B64D11/02</u> <u>E03D11/00</u> <u>E03D11/02</u> (+7)	B64D11/02 E03D11/02 E03D11/17 (+2)	US2016272320 (A1) 2016-09-22	2012-11-21

☐ 2. **Automic nonelectric closetool**

★	Inventor:	Applicant:	CPC:	IPC:	Publication info:	Priority date:
	LEE TUNG SHAN [CN] LEE HO FAN [CN] (+1)	LEE TUNG SHAN [CN] LEE HO FAN [CN] (+1)	<u>A47K13/10</u> <u>E03D1/34</u> <u>E03D2009/028</u> (+3)	A47K13/10 E03D1/34 E03D5/02 (+2)	US2016258150 (A1) 2016-09-08	2014-07-02

☐ 3. **DEVICE FOR DISPENSING AN ACTIVE-SUBSTANCE PREPARATION INTO A **TOILET** BOWL**

★	Inventor:	Applicant:	CPC:	IPC:	Publication info:	Priority date:
	ZUECHNER LARS	HENKEL AG & CO KGAA [DE]	E03D2009/024	E03D9/03	US2016251840 (A1)	2013-06-05

Advanced search

Select the collection you want to search in 

Worldwide - collection of published applications from 90+ countries



Enter your search terms - CTRL-ENTER expands the field you are in

Enter keywords

Title: 

plastic and bicycle

Title or abstract: 

hair

toilet and flush*

Enter numbers with or without country code

Publication number: 

WO2008014520

WO or EP

Application number: 

DE201310112935

Priority number: 

WO1995US15925

Enter one or more dates or date ranges

Publication date: 

2014-12-31 or 20141231

1996:2016

Result list

☐ Select all (0/25)

 Compact

 Export (CSV | XLS)

 Download covers

 Print

Approximately **1,162** results found in the Worldwide database for:

toilet and flush* in the title or abstract AND **WO or EP** as the publication number AND **1996:2016** as the publication date

Only the first **500** results are displayed.

1 ▶

Results are sorted by date of upload in database

☐ 1. **TOILET**

★	Inventor:	Applicant:	CPC:	IPC:	Publication info:	Priority date:
	LEBEDEV ANATOLY ANATOLIEVICH [UA]	LEBEDEV ANATOLY ANATOLIEVICH [UA]		E03D9/05 E03D9/052	WO 2016 148669 (A1) 2016 -09-22	2015-03-17

☐ 2. **SIPHON ACTIVATED VALVE**

★	Inventor:	Applicant:	CPC:	IPC:	Publication info:	Priority date:
	LE TUAN [US]	FLUIDMASTER [US]		F16K31/18 F16K31/20	WO 2016 145442 (A1) 2016 -09-15	2015-03-12

☐ 3. **FLUSH TOILET UNIT**

★	Inventor:	Applicant:	CPC:	IPC:	Publication info:	Priority date:
	KONDO YASUHIRO [JP] MATSUBARA HIKARU [JP]	LIXIL CORP [JP]		E03D11/08	WO 2016 143029 (A1) 2016 -09-15	2015-03-09

FLUSHING SYSTEM FOR A PRESSURIZED TOILET

Page bookmark [WO2015020928 \(A2\) - FLUSHING SYSTEM FOR A PRESSURIZED TOILET](#)

Inventor(s): ROESER JACK O ±

Applicant(s): FIRST AMERICAN BANK [IL] ±

Classification: - international: [E03D3/10](#); [E03D5/092](#)

- cooperative: [E03D3/10](#)

Application number: WO2014US49532 20140804

Priority number(s): [US201313957953](#) [20130802](#)

Also published as: [WO2015020928 \(A3\)](#) [US2015033463 \(A1\)](#)

Abstract of WO2015020928 (A2)

Translate this text into [i](#)

Select language ▼



powered by EPO and Google

A **toilet** system including a bowl and a tank configured to hold water and air and deliver water to the bowl. The tank includes a water inlet and outlet. A valve moves between an open position and a closed position, and the valve closes the outlet when the valve is in the closed position. The system includes a lever positioned to engage the valve and a plunger that is configured to engage the lever. The tank includes a container that holds water and pressurized air above the water. The container is positioned such that the water and pressurized air in the container apply a force to the lever through the plunger which causes the lever to move the valve from the closed position toward the open position in order that water can **flush** and refill the **toilet** bowl and air can flow into the tank and container.

The EPO does not accept any responsibility for the accuracy of data and information originating from other authorities than the EPO; in particular, the EPO does not guarantee that they are complete, up-to-date or fit for specific purposes.

CLAIMS

1. A pressurized flush toilet system, comprising: a bowl; a tank configured to hold water and to deliver water to said bowl, said tank including an inlet that delivers water into said tank and an outlet that allows water to exit said tank; a valve being configured to move between an open position and a closed position, wherein said valve closes said outlet of said tank when said valve is in said closed position; a lever positioned to engage said valve; a plunger that extends out of said tank and that is configured to engage said lever, said plunger being movable with respect to said tank; and a container configured to hold water and compressed air and being positioned in said tank such that water and compressed air held in said container apply a force to said plunger such that said plunger applies a force to said lever which causes said lever to move said valve from said closed position toward said open position.
9. A pressurized flush toilet system, comprising: a bowl; a tank configured to hold water and to deliver water to said bowl, said tank including an inlet that delivers water into said tank and an outlet that allows water to exit said tank; a valve being configured to move between an open position and a closed position, wherein said valve closes said outlet of said tank when said valve is in said closed position; a lever positioned to engage said valve; and a container configured to hold water and compressed air and being positioned in said tank such that water and compressed air held in said container apply a force and at least a portion of that force is applied to said lever which causes said lever to move said valve from said closed position toward said open position.
15. A pressurized flush toilet system, comprising: a bowl; a tank configured to hold water and to deliver water to said bowl, said tank including an inlet that delivers water into said tank and an outlet that allows water to exit said tank; a valve being configured to move between an open position and a closed position, wherein said valve closes said outlet of said tank when said valve is in said closed position; a container configured to hold water and compressed air and being positioned in the tank; and a plunger that is moveable with respect to said tank and that is positioned proximate said container such that water and compressed air in said container apply a force to said plunger and at least a portion of that force is applied from said plunger to said valve to move said valve from said closed position toward said open position.

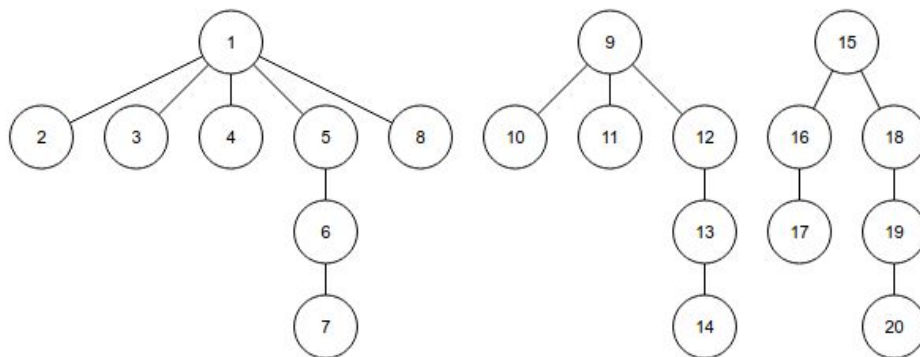

Patentscope - WIPO

<https://patentscope.wipo.int/>



PATENTSCOPE

Search International and National Patent Collections

[Mobile](#) | [Deutsch](#) | [Español](#) | [Français](#) | [日本語](#) | [한국어](#) | [Português](#) | [Русский](#) | [中文](#) | [العربية](#)

WORLD INTELLECTUAL PROPERTY ORGANIZATION

[Search](#)

[Browse](#)

[Translate](#)

[Options](#)

[News](#)

[Login](#)

[Help](#)

[Home](#) > [IP Services](#) > [PATENTSCOPE](#)

Simple Search

Using PATENTSCOPE you can search 58 million patent documents including 3 million published international patent applications (PCT). Detailed coverage information can be found here ([->](#))

Full Text



toilet flushing



Office: All

[Search](#)

PCT Publication 38/2016 (2016/09/22) is now available. The next publication date is scheduled as follows: Gazette number 39/2016 (2016/09/29). [More](#)

Results 1-10 of 14,670 for Criteria: ALLTXT:(toilet flushing) Office(s):all Language:EN Stemming: true



prev

1

2

3

4

5

6

7

8

9

10

next

Page: 1 / 1468

Go >

Refine Search

ALLTXT:(toilet flushing)

Search

RSS



Analysis

Sort by:

Relevance

View

All

List Length

10

Machine translation

Int.Class	Appl.No	Title	Applicant	Ctr	PubDate
1. 103510606	Flushing foam toilet bowl			CN	15.01.2014
E03D 11/17	201210213762.0	史春龙		史春龙	
<p>The invention provides a flushing foam toilet bowl. The flushing foam toilet bowl comprises a toilet bowl body, a flushing system and a blowoff pipe. The flushing foam toilet bowl is characterized by comprising the blowoff pipe of a fold-back structure, a drain trap, a foam covering system and a quickly-flushing structure. The drain trap can enable the bottom of the toilet bowl to form the water seal depth which is more than 50mm, the foam covering system can generate foam and convey the foam to a water seal of the toilet bowl, and the quick-flushing structure can increase the flowing speed of water in the blowoff pipe and then discharge the foam out of the blowoff pipe. According to the flushing foam toilet bowl, the problem of foam discharge in the drain trap of the toilet bowl is solved, and application of a foam covering technology in the field of bathrooms is enriched.</p>					
2. 104563243	Toilet bowl flushing controller			CN	29.04.2015
E03D 5/10	201310499114.0	QINGDAO ENGAO MOTION CONTROL TECHNOLOGY CO., LTD.		DING ZHAOJIE	
<p>The invention discloses a toilet bowl flushing controller. The toilet bowl flushing controller comprises a toilet bowl and an induction device, wherein the induction device comprises an infrared inductor; the infrared inductor is connected with a power controller; the power controller is connected with a power supply of a toilet bowl flushing switch; and the induction device is arranged in the toilet bowl and is connected with a timing alarm. The toilet bowl flushing controller is simple in structure; and the induction device is connected with the power controller, and the circumstance that people forget to flush the toilet bowl after using the toilet bowl is avoided.</p>					

Permanent Link/ Bookmark: 

Application Number: 201210213762.0 **Application Date:** 27.06.2012

Publication Number: 103510606 **Publication Date:** 15.01.2014

Grant Number: 103510606 **Grant Date:** 02.12.2015

Publication Kind : B

IPC:
E03D 11/17 
E03D 1/38
E03D 11/18
E03D 9/00

Applicants: 史春龙
Inventors: 史春龙
Agents: 南京钟山专利代理有限公司 32252
Priority Data:

Title:
(EN) Flushing foam toilet bowl
(ZH) 一种冲水泡沫便器

Abstract: (EN) The invention provides a flushing foam toilet bowl. The flushing foam toilet bowl comprises a toilet bowl body, a flushing system and a blowoff pipe. The flushing foam toilet bowl is characterized by comprising the blowoff pipe of a fold-back structure, a drain trap, a foam covering system and a quickly-flushing structure. The drain trap can enable the bottom of the toilet bowl to form the water seal depth which is more than 50mm, the foam covering system can generate foam and convey the foam to a water seal of the toilet bowl, and the quick-flushing structure can increase the flowing speed of water in the blowoff pipe and then discharge the foam out of the blowoff pipe. According to the flushing foam toilet bowl, the problem of foam discharge in the drain trap of the toilet bowl is solved, and application of a foam covering technology in the field of bathrooms is enriched.

(ZH)

本发明提供了一种水冲泡沫便器,包括便器主体,冲水系统,排污管,其特征在于,具有:折回形结构的排污管,能使得便器底部能形成50mm以上水封深度的存水弯,能够产生气水泡沫并将其输送到所述便器水封上的泡沫覆盖系统,能够加速所述排污管内水流动速度进而将所述泡沫冲出所述排污管的快冲结构。通过本发明解决了存水弯便器中泡沫排出的问题,丰富了泡沫覆盖技术在卫浴领域的应用。

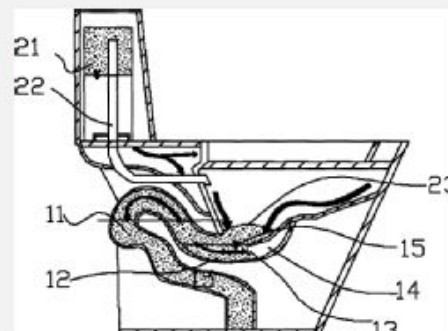

USPTO (<http://www.uspto.gov/patents-application-process/search-patents>)

Search for patents

New to Patent Searching? See this important information about searching for patents:

[How to Conduct a Preliminary U.S. Patent Search: A Step by Step Strategy](#) - Web Based Tutorial (38 minutes)

- [The Seven Step Strategy](#) - Outlines a suggested procedure for patent searching
- A [detailed handout](#) of the Seven Step Strategy with examples and screen shots.

Patents may be searched using the following resources:

- [USPTO Patent Full-Text and Image Database \(PatFT\)](#)
- [USPTO Patent Application Full-Text and Image Database \(AppFT\)](#)
- [Global Patent Search Network \(GPSN\)](#)
- [Patent Application Information Retrieval \(PAIR\)](#)
- [Public Search Facility](#)
- [Patent and Trademark Resource Centers \(PTRCs\)](#)
- [Patent Official Gazette](#)
- [Common Citation Document \(CCD\)](#)
- [Search International Patent Offices](#)
- [Search Published Sequences](#)
- [Patent Assignment Search](#)

<https://patents.google.com/>



☐ Include non-patent literature (Google Scholar)

Search and read the full text of patents from around the world.

SEARCH TERMS

toilet × + Synonym

flushing × + Synonym

+ Search term or CPC

SEARCH FIELDS

 Before priority YYYY-MM-DD + Assignee

MORE ▾

About 58,645 results ordered by relevance ▾ grouped by classification ▾

E03D5/105?

Special constructions of flushing devices, e.g. closed flushing system operated electrically, e.g. by a photo-cell; also combined with devices for opening or closing shutters in the bowl outlet and/or with devices for raising/or lowering seat and cover and/or for swiveling the bowl touchless, e.g. using sensors

Capacity operated automatic flushing system



Grant US3314081A • Carl E Atkins • Tung Sol Electric Inc

Priority 1964-05-22 • Filing 1964-05-22 • Grant 1967-04-18 • Publication 1967-04-18

1. AN AUTOMATIC FLUSHER FOR A **TOILET** COMPRISING: (A) CAPACITY SENSITIVE MEANS FOR DETECTING BODY CAPACITY IN THE AREA OF USE OF THE **TOILET**; (B) ACTUATING MEANS FOR **FLUSHING THE TOILET**; (C) MEANS RESPONSIVE TO SAID BODY CAPACITY FOR ...

[→ Search within classification E03D5/105 \(39,096 results\)](#)

Urinal attachment for toilet bowl



Grant US3500480A • John H Michal Jr • John H Michal Jr

Priority 1966-07-01 • Filing 1968-07-30 • Grant 1970-03-17 • Publication 1970-03-17

Still further, from the economic standpoint, it is a known fact that approximately 5 gallons of water usually is required to **flush** a conventional **toilet** bowl, and the use of this much water to **flush a toilet** after a single urinary use ...

Touch Free Hygienic Display Control Panel For A Smart Toilet

Abstract

A touch free **toilet** control panel display which may be used, for activating various components of a smart **toilet**. The user may touch freely use a touch free input device, for choosing from a displayed menu of **toilet** functions. Various input devices may used to activate the displayed **toilet** devices, such as, a floating capacitive field (404) to detect a user's fingers hovering above the displayed menu options (406), body movement recognition used to control the movement of a displayed cursor, an eye tracking system (604), that uses the user's gaze point (610), tongue recognition, etc. Touch free activation of the menu functions, reduces the transmission of bacteria from the menu panel to the user, and may also ease the use of the **toilet** devices. The display menu may show **toilet** devices, such as, a bidet, bidet water temperature, internet connection, etc. Other embodiments are described and shown.

Images (23)

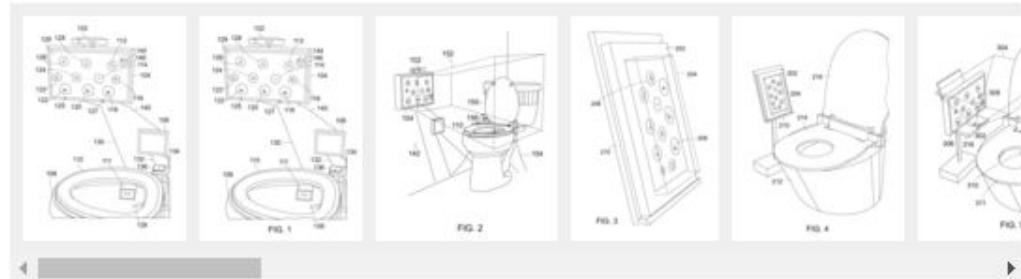

Classifications

US20150000025A1

US Application



Download PDF



Find Prior Art

Legal status: Pending

Application number: US13927111

Inventor: [sigmund lindsay clements](#)

Original Assignee: [sigmund lindsay clements](#)

Priority date: 2012-06-27

Filing date: 2013-06-26

Publication date: 2015-01-01

Info: [Patent citations \(3\)](#), [Cited by \(13\)](#), [Also published as \(2\)](#), [Similar documents](#)

External links: [USPTO](#), [USPTO Assignment](#), [Espacenet](#), [Discuss](#)

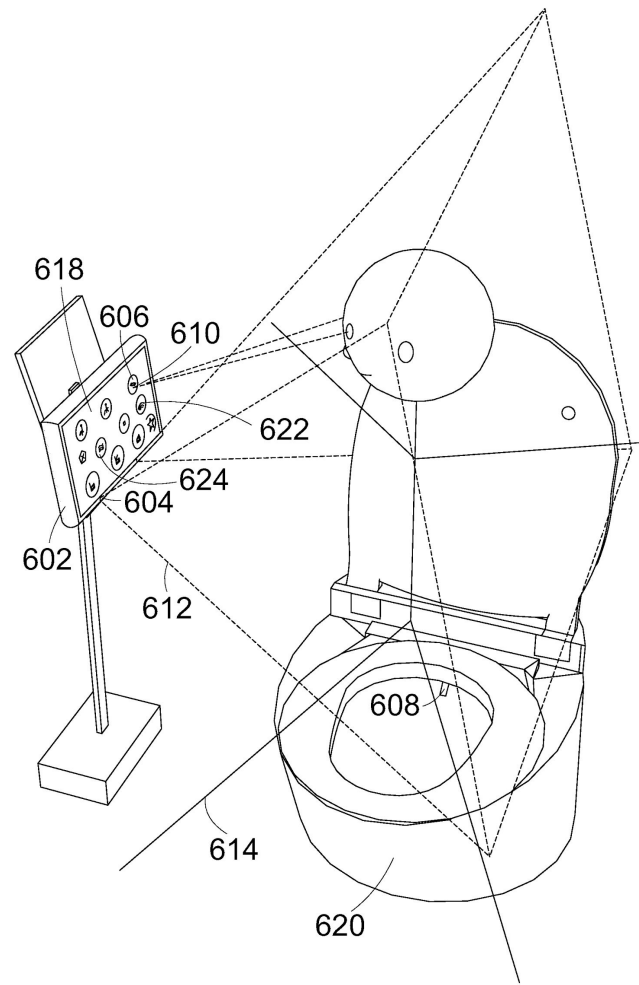
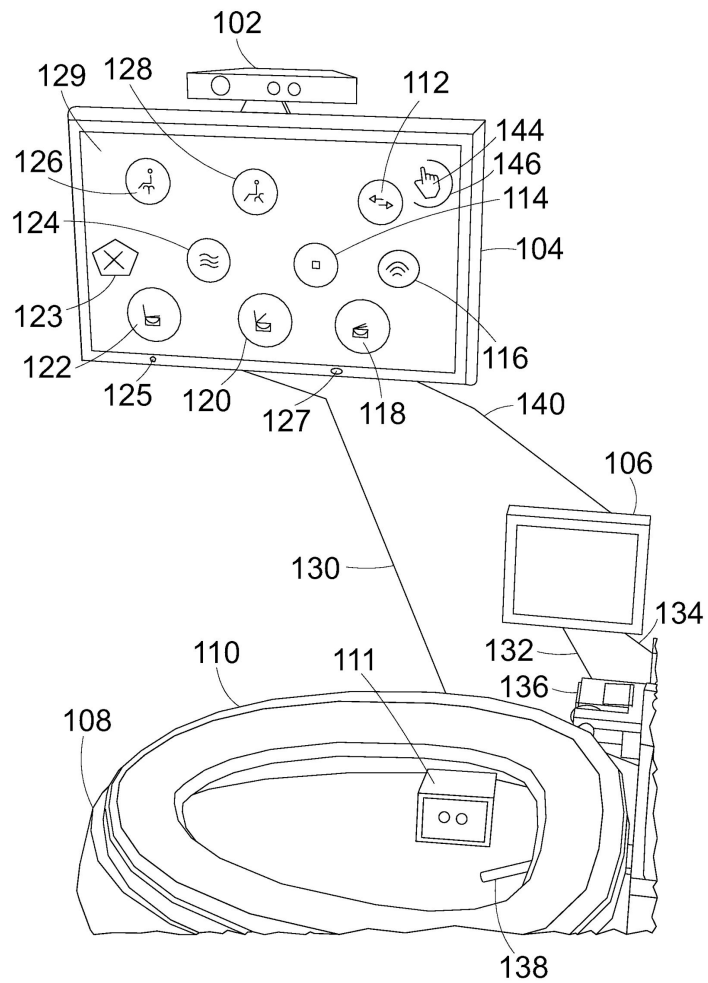

FIG. 8



B64D11/06

Arrangements of seats, or adaptations or details specially adapted for aircraft seats

Modular **cabin segment**, **cabin** for a vehicle and vehicle with a **cabin**

Application US20130334369A1 • Ralf Schliwa • Airbus Operations GmbH

Priority 2010-02-19 • Filing 2013-08-16 • Publication 2013-12-19

A modular **cabin segment** for a vehicle includes a first lateral **segment** module that accommodates a first **toilet** arrangement with at least one **toilet compartment** and a second lateral **segment** module, wherein in each case an outer lateral face ...

cabin module for passenger aircraft

Application FR2842497A1 • Jalmes Bruno Saint • Airbus

Priority 2002-07-19 • Filing 2002-07-19 • Publication 2004-01-23

<P> This **cabin** module of aircraft comprises: - two transverse walls (12) extending from a longitudinal **cabin** wall (4) to a passage (8) longitudinally, at least one of these transverse walls (12) having a transparent portion (44), - a ...

→ [Search within classification B64D11/06 \(352 results\)](#)

Self-supporting **cabin** structure

Application US20090250554A1 • Ulrike GRAEBER • Airbus Deutschland GmbH

Priority 2006-10-12 • Filing 2009-04-08 • Publication 2009-10-08

A **cabin** structural unit for attaching **cabin** installation elements is provided for an aircraft. The **cabin** structural unit is set up in such a way that a **cabin** installation element is attachable. The **cabin** structural unit is implemented as ...

<https://scholar.google.cz/>



https://www.upv.cz



Úřad průmyslového vlastnictví

[Česky](#) | [Deutsch](#) | [English](#) | [Français](#)



[Home](#) | [ÚPV](#) | [Průmyslová práva](#) | [Služby úřadu](#) | [Právní předpisy](#) | [Užitečné odkazy](#) | [Publikace](#) | [Vzdělávání](#) | [Smlouvy](#) |



Vynálezy/Patenty

- [Vynález a jeho ochrana](#)
- [Elektronické podávání a formuláře](#)
- [Poplatky](#)

Ochranné známky

- [Ochranná známka a její ochrana](#)
- [Elektronické podávání a formuláře](#)
- [Poplatky](#)

Užité vzory

- [Užitný vzor a jeho ochrana](#)
- [Elektronické podávání a formuláře](#)
- [Poplatky](#)

Průmyslové vzory

- [Průmyslový vzor a jeho ochrana](#)
- [Elektronické podávání a formuláře](#)
- [Poplatky](#)

Označení původu / Zeměpisná označení

- [Označení původu a jeho ochrana](#)
- [Elektronické podávání a formuláře](#)
- [Poplatky](#)

Online databáze

- [Databáze ÚPV](#)
- [EPO](#)
- [WIPO](#)
- [EUIPO](#)
- [Systémy třídění](#)

VÍTE, U KOHO REGISTRUJETE
SVÁ PRŮMYSLOVÁ PRÁVA?
**POZOR NA RIZIKA REGISTRACE
U NĚKTERÝCH KOMERČNÍCH SUBJEKTŮ**

Aktuality

[10.11. - Seminář: Podpora proexportního potenciálu českých firem a práva duševního vlastnictví](#)

[Aktualizace Společného prohlášení o společné praxi týkající se obecných označení ze záhlaví tříd Niceského třídění](#)

[26.10. - Seminář: Databáze ochranných známek](#)

[20.-22.6.2018 Mezinárodní výstava technických novinek, patentů a vynálezů -](#)

Kontakt

Úřad průmyslového vlastnictví
Antonína Čermáka 2a
160 68 Praha 6 - Bubeněč

Tel/Fax: 220 383 111 / 224 324 718
E-mail: posta@upv.cz

Adresa datové schránky: ix6aa38

Helpdesk:

E-mail: helpdesk@upv.cz

Tiskový mluvčí:

[Upload search results](#)[Upload patent family](#)[Close](#)[Tag search](#)[Search Manager](#)[Number search](#)[Tags Manager](#)[Resources](#)

Filter by search term:

[Display selected](#)[Mark visible](#)[Clear selected](#)☐ *Load filename: results.csv (nicmila@gmail.com - 2016-03-17)*[Delete from server](#)

265 results found in the Worldwide database for: EP or WO as the publication number AND Unilever as the applicant AND A23D7/005 or A23D7/02 as the IPC classification
Hits: 265

[Display hits](#)☐ *Load filename: results (5).csv (nicmila@gmail.com - 2016-03-17)*[Delete from server](#)

37 results found in the Worldwide database for: EU or WO as the publication number AND A23D7/04 as the IPC classification
Hits: 25

[Display hits](#)☐ *Load filename: results (3).csv (nicmila@gmail.com - 2016-03-17)*[Delete from server](#)

Approximately 246 results found in the Worldwide database for: GB as the publication number AND A23D7/005 or A23D7/02 as the IPC classification
Hits: 237

[Display hits](#)

[Tag search](#)[Search Manager](#)[Number search](#)[Tags Manager](#)[Resources](#)[? 1:Relevant](#)[? 5:May_interest](#)[? 9:Irrelevant](#)[? See Family](#)

ALL - EP - WO || A1 - A2 - A3

CPC:

IPC:

Years: 14 - 12 - 11 - 02 - 88

Hide: ☐ with tags | ☐ with family | ☐ 8:... | ☐ 9:...

Appl. No. WO2014FI50964

[Espacenet](#) [Google](#) [Patentscope](#)

Appl. date: 2014-12-08

MILK BASED FAT MIXTURE AND A PROCESS FOR PRODUCING IT

[WO2015086897A1](#) [Priority number(s):FI20130006239 20131209]

CPC:

IPC: [A23C19/076](#), [A23C19/093](#), [A23C9/13](#), [A23D7/005](#)

Patent family:

[Expand](#)

[WO2015086897](#)

Tags: [+ New](#)

[- 1:Relevant](#)

Notes: [Expand](#) [Collapse](#)

A process for the manufacture of a fat mixture, characterized in that said process comprises the steps where 85-15 wt% of milk base selected from mixtures of non-acidified milk base and acidified milk base, is mixed with 15-85 wt% of edible plant oil followed by mixing to obtain the fat mixture, the percentages being calculated from the total weight of the fat mixture.

Šedá literatura

